

**TOWN OF PLYMOUTH CAPITAL IMPROVEMENT PLAN REQUEST
FY26 FALL ANNUAL TOWN MEETING**

Department: DPW - Parks & Forestry	Priority #:	1
Project Title and Description: Training Green ADA Upgrades	Total Project Cost:	\$744,000

Department/Division Head: Nick Faiella

Check if project is: New ☒ Resubmitted ☐ **Cost estimate was developed:** Internally ☐ Externally ☒

For project re-submittals, list prior year(s):

List any funding sources and amounts already granted: \$100,000 from the Visitor's Service Board

Basis of Estimated Costs (attach additional information if available)			If project has impact on 5 Year Plan and future operating budgets, insert estimated amounts.		
Capital:	Cost	Comments	Fiscal Year:	Capital	Operations & Maintenance
<i>Planning and Design</i>			FY27		
<i>Labor and Materials</i>	\$607,860		FY28		
<i>Administration</i>			FY29		
<i>Land Acquisition</i>			FY30		
<i>Equipment</i>			FY31		
<i>Other</i>	\$14,000				
<i>Contingency</i>	\$122,000				
Total Capital					

Project Justification and Objective: Walkways are cracked & crumbled, and are beginning to be unsafe for walking and leisure activities. Upgrades would include ADA compliant entries and walkways, MAAB compliant stairway entrances, LED lighting areas of the park and flagpole, and irrigation. The upgrades would keep the park safe for pedestrians, while preserving it's historic beauty.

For Capital Project Requests:

Will this project be phased over more than one fiscal year? If yes, enter it on the 5 Year Plan Yes ☐ No ☒
Can this project be phased over more than one fiscal year? Yes ☐ No ☒

For Capital Equipment Requests:

☐ Check if equipment requested is replacement and enter the year, make & model, VIN and present condition of existing equipment

What is the expected lifespan of this new/replacement equipment: _____

Attach backup information, estimates, or justification to support this request.

**.APPLICATION FOR COMMUNITY PRESERVATION FUNDING
TOWN OF PLYMOUTH
26 COURT STREET
PLYMOUTH, MA 02360**

Submit to: Community Preservation Committee

Name of Applicant/Contact Person:	Nick Faiella – Parks and Forestry Superintendent
Sponsoring Organization/ Co-Applicant if Applicable:	CPC and Visitor Service Board
Mailing Address:	169 Camelot Drive , Plymouth MA, 02360
Daytime Phone:	508-830-4196 x12112
Property Owner Name:	
Email:	NFaiella@plymouth-ma.gov
Email:	NFaiella@plymouth-ma.gov
Project Name:	Plymouth Training Green ADA Improvements and Upgrades
Date:	5/15/25

Total Project Cost	CPA Funds Requested	Cost Share Amount	Cost Share Percent
\$744,000	\$644,000	\$100,000	13%

Assessor's Map Number	Map 19	Assessor's Lot/Parcel Number	238
Deed Book Number	Please see attachment 4	Deed Page Number	Please see attachment 4

Attach separate sheet if more than one lot/parcel/deed book/deed page number

Attach a copy of the Assessor's Map(s) with the project parcel outlined (if appropriate for your project)

CPA Category (YOU MUST CHECK OFF A MINIMUM OF ONE CATEGORY, but may identify more than one category, if applicable to your project)

- Open Space ☐

PROJECT DESCRIPTION:

- **All of the following MUST be answered in the space provided.**
- Applications will be returned as incomplete if all relevant requested information is not provided.
- Include supporting materials and exhibits as necessary.

- Please refer to the Plymouth Community Preservation Criteria before and while completing this application.
1. **Describe the project.** *Affordable Housing Projects requests please include -total number of units, bedroom count per unit, total percentage of affordability, ownership/rental, local preference is required.*

The Plymouth Training Green, originally used as a perpetual common or training place in 1711, was later designed to have curbing and walkways in 1889, by the famous landscape architect known as Fredrick Law Olmstead. The park is known to be one of the oldest continuously used parks in the country. Currently, the walkways are cracked and crumbled and are beginning to be an unsafe area for walking and leisure activities. This design and engineering plan would address these safety issues by including improvements such as ADA compliant entries and walkways, MAAB compliant stairway entrances, LED lighting to areas of the park and flagpole, and an irrigation system to keep the grass green during the summer months, all while keeping the design true to Olmstead's original design. These improvements would not only bring aesthetically pleasing qualities but would make pedestrian travel safe within the park.

2. **Goals:**

a. What are the goals of the proposed project?

The Goal is to improve this park by making ADA improvements and upgrades, address safety concerns, and improve the park aesthetically, while preserving the historic beauty of the park's natural state. The plan will be to keep the design of the park as close as possible to the original design of Frederick Law Olmstead, which was done in 1889.

b. Who will benefit and why?

All visitors, local and tourists alike, will benefit from this park by observing its beautiful yet simple landscape and historical monuments related to Frederick Law Olmstead's design, and symbolization of recognition of the Civil War and the War of 1812. Aspects of the park will have added lighting and ADA access inclusive components.

c. How will success be measured?

Success will be measured by naturally observing the volume of visitors after project completion. In addition, adding ADA access routes will ensure that more visitors can access different areas of the park.

3. **Community Preservation Committee Criteria:**

How does the project fulfill the General and Specific Criteria of the Community Preservation Committee Guidelines? (Refer to the specifications in the Guidelines)

This project would be considered historical preservation, and preservation of open space.

4. Community Need:

a. How does the community benefit from this project?

The community would benefit by addressing safety issues by including improvements such as ADA compliant entries and walkways, MAAB compliant stairway entrances, LED lighting to areas of the park and flagpole. Adding an irrigation system would keep the grass green during the summer months, all while keeping the design true to Olmstead's original design. These improvements would not only bring aesthetically pleasing qualities to this park for the community but would also make pedestrian travel safer within the park.

b. If applicable, explain how this project addresses needs identified in existing Town plans? (Such as the Open Space and Recreation Plan, Community Plan, Master Plan, Housing Production Plan.

5. Community Support:

a. What is the nature and level of support? Include letters of support from any Town boards or community groups that have endorsed the project.

Attached:
VSB Grant funding award MEMO
Precinct 3 - Additional Letter of Support

6. Budget:

Budget Summary

Total Project Cost	CPA Funds Requested	Cost Share Amount	Cost Share Percent
\$ 744,000	\$644,000	\$100,000	13 %

Equipment is generally defined as an item with a useful life expectancy of more than one year.

Supplies are defined as an item with a useful life of less than one year.

Construction means all types of work done on a particular property or building including erecting, altering or remodeling.

Budget Categories (Leave any category blank if not applicable to your project)

	CPA FUNDS	OTHER FUNDS (cost share)	TOTAL
Personnel			
Equipment			
Supplies			
Contractual			
Construction	\$644,000	\$100,000	\$744,000
Other			
TOTAL			

note: CPA FUNDING FOR ANY CATEGORY REQUIRES COMPETITIVE BIDDING unless you can provide a sole source justification for any category not competitively selected

****Attach a minimum of one recent bid****

Budget Cost Sharing

Identify the amount of cost sharing for this project. Sources include private, federal, state or local government, or any other sources.

Organization	Item	Amount	Type (cash, in-kind, etc.)
Visitor Service Board	To offset total cost	\$100,000	Grant funds

7. Funding:

- Attach commitment letters from any organization providing a cost share contribution listed in the table above.
- Describe any other attempts (including unsuccessful) to secure funding for this project.

The Parks and Forestry Superintendent formally requested funds from the Visitor Service Board, in the amount of \$100,000, mainly to be applied to the costs for construction of walkways/paths and a portion of the decorative lighting, but ultimately to offset total project cost. The funding request was granted for the full request of \$100,000. The VSB was very supportive of the project.

- Are any "Other Funds" in the budget in-kind? If yes, describe how the value of the in-kind contribution was derived. (In-kind contributions can be defined as a contribution of services or property, donated equipment, buildings or land, or donated supplies)

The Parks and Forestry budget does not have other funds available to apply for this cost. However, the maintenance of this project, once completed, will be performed by the Parks and Forestry Division, and funding to do so will be supported by the Parks and Forestry Salaries and Operating budgets.

8. **Timeline:**

Provide a schedule for project implementation, including a timeline for starting and ending major tasks and project completion.

If funds are granted for this project, the project would go out to bid shortly thereafter. The total project completion time could take up to one year.

9. **Implementation:**

a. Project Manager Contact Information

Who will be the Project manager	Nick Faiella
Daytime Phone:	508-830-4162 x 12112
Evening Phone:	""
Email:	nfaiella@plymouth-ma.gov

10. **Maintenance:** (LEAVE BLANK IF NOT APPLICABLE TO YOUR PROJECT)

a. If ongoing maintenance is required, who will be responsible for it?

The Parks and Forestry Division.

b. How will it be funded?

This will be funded by the Parks and Forestry Operating and Salaries budget.

Maintenance Budget

Year one	Year two	Year three	Year four	Year five
\$	\$	\$	\$	\$

Please note that for affordable housing developments, a complete set of financials for the development shall be included, including a statement of income by affordability and unit type, a statement of stabilized operations, a hard and soft cost development budget, and sources of funding.

11. Site Documentation: (Submit 3 copies only)

Attach documentation that you have control over the site, such as a Purchase and Sale Agreement, option or deed.

ADDITIONAL INFORMATION: (NOT REQUIRED BUT RECOMMENDED IF APPLICABLE)

12. Project Documentation: (Submit 3 copies only)

Attach any applicable engineering plans, architectural drawings, site plans, any other renderings, relevant studies or material.

13. Other Information: Any additional information that might benefit the CPC in consideration of this project.

Attachments:

- #1. Letter of Support #2. VSB MEMO #3. Cost Analysis
#4. Parcel Information #5. 60% Design/Plans

Please deliver signed application to Kristin Ford, Community Preservation Committee, Coordinator and email a digital copy to kford@plymouth-ma.org phone 1-508-322-3139

TO THE BEST OF MY KNOWLEDGE AND BELIEF, ALL DATA IN THIS APPLICATION ARE TRUE AND CORRECT. THE DOCUMENT HAS BEEN DULY AUTHORIZED BY THE INDIVIDUAL OR GOVERNING BODY OF THE APPLICANT.		
Authorized Representative		
First Name Nick	Last Name Faiella	
Title Parks and Forestry Superintendent	Telephone Number 508-830-4162 x12112	
Email: Nfaiella@plymouth-ma.gov	Fax Number	
Signature of Authorized Representative 		Date Signed 5/23/25



#1

Community Preservation Committee

Mr. Ed Bradley, Chairman

Town of Plymouth 26 Court Street

Plymouth Ma

02360

May 22, 2025

Chairman Bradley,

I am writing on behalf of and with the consensus of the Precinct 3 Town Meeting Delegation, of the May 15, 2025 Application submitted to your committee by Mr. Nick Faiella, Parks and Forestry Superintendent for ADA Improvement and Upgrades at the Plymouth Training Green.

As a courtesy reminder Precinct 3 submitted our own Application for this project back in July of 2023 for Improvements to this Historic Park and Monument located on Lot and Plot 238 in Assessors Map 19, but it languished until it was decided that since this is a Town owned lot the project would be best filed by the Town itself.

This historic Monument dedicated in 1869 and expanded and improved twenty years later by renowned Architect F. L. Olmsted is in need of a modern day facelift honoring the original efforts of the Town. We are in full support of the plans presented to us by Mr. Faiella!

Please accept this letter as our continued support of the project, and the efforts of Nick Faiella, to bring this beautiful and Historic Plymouth Memorial Park, honoring the service of Plymouth Citizens in past conflicts up to ADA compliance and to restore and upgrade its original beauty as its walkways are in deplorable condition and present an immediate and ongoing safety hazard.

Thank you in advance for your anticipated support,

Respectfully,

A handwritten signature in blue ink, reading "Dale M. Webber", written over a horizontal line.

Dale Webber, Chairman

A handwritten signature in blue ink, reading "Gerald Sirrico", written over a horizontal line.

Gerald Sirrico, Vice Chairman



Town of Plymouth

Visitor Services Board

#2

TO: Nicholas Faiella, Superintendent Parks & Forestry
Town of Plymouth

FROM: Steve Lydon, Chairman
Visitor Services Board

RE: Town Promotion Funding

DATE: March 20, 2025

Congratulations! Based on the merits of your grant application, the Visitor Services Board has voted the following funding from the FY26 Town Promotion Fund.

Flower Baskets	Grant Funding: \$8,598.00
Celebration Light Pole Strings	Grant Funding: \$1,500.00
Holiday Linden Tree Lights	Grant Funding: \$1,500.00
Holiday Wreaths for Downtown	Grant Funding: \$4,050.00
Labor to maintain Celebration Lights	Grant Funding: \$10,000.00
Plymouth Training Green Walkways/Lighting	Grant Funding: \$100,000.00

This funding is conditioned on a number of items as outlined in the initial application.

Please keep in mind, there is a limited amount of funds for the awarding of grants.

It is imperative that each completes all necessary information before any funds may be released. Funds will be available upon receipt and review of completed documentation, after July 1, 2025. Once the program/project is complete, please submit all associated documentation. In fairness to all applicants, the Town of Plymouth Visitor Services Board reserves the right to deny and/or withdraw any funds for non-compliance.

The funding is based upon available funds in the Promotion Fund, the amount of requests received and the information you submitted with your application. Please note, you are solely responsible for the timely payment of all expenses incurred from your program/project.

Should you have any questions, please contact Laurie Maiolini-Ayotte at the Office of Economic Development at (508) 322-3325.

Plymouth Training Green Improvements
Plymouth, Massachusetts
Prepared For: Plymouth Parks & Forestry Department
SLR # 11982.00028

December 2, 2024

60% Opinion of Probable Construction Costs - NOT FOR CONSTRUCTION

	ITEM	UNIT	QTY	UNIT PRICE	COST
SITE PREPARATION					
1	Gen. Conditions, Mobilization, Staking, Temp Construction Fencing, Misc. Removals	PERC.LNI	10%	\$ 542,700	\$ 54,270
2	Maintenance & Protection of Traffic	PERC.THI	2%	\$ 542,700	\$ 10,854
3	Remove Concrete Walk	SY	670	\$ 20	\$ 13,400
4	Sediment & Erosion Control - Compost filter tube	LF	905	\$ 4	\$ 3,620
5	Remove Concrete Curb	LF	0	\$ 10	\$ 0
6	Sawcut Bituminous Concrete	LF	100	\$ 8	\$ 800
7	Remove Bituminous Concrete	SY	20	\$ 8	\$ 160
8	Remove Granite Curb	LF	75	\$ 10	\$ 750
9	Remove Stair Railing	LF	10	\$ 75	\$ 750
10	Remove Benches	EA	4	\$ 500	\$ 2,000
11	Tree Root Pruning	LS	1	\$ 7,500	\$ 7,500
12	Tree Protection	EA	10	\$ 350	\$ 3,500
SITE IMPROVEMENTS					
13	Reset Stone Paver	SF	85	\$ 75	\$ 6,375
14	Reset granite curb	LF	30	\$ 35	\$ 1,050
15	Granite Curb - New	LF	16	\$ 65	\$ 1,040
16	Concrete Pedestrian Drop Ramp	EA	4	\$ 1,200	\$ 4,800
17	Detectable Warning Paver - Cast Steel	EA	5	\$ 1,000	\$ 5,000
18	Concrete Walk	SF	6,800	\$ 12	\$ 81,600
19	Bituminous Concrete Roadway Repair	SY	20	\$ 80	\$ 1,600
20	Pavement Markings	SF	905	\$ 4	\$ 3,620
21	Pedestrian Lighting 16' pole ht. (with foundation)	EA	6	\$ 10,000	\$ 60,000
22	Electrical Site Work	LS	1	\$ 125,000	\$ 125,000
23	Lights (Monument & Flagpole)	EA	6	\$ 2,500	\$ 15,000
24	Bench (install only)	EA	4	\$ 500	\$ 2,000
25	Trash/Recycling Receptacles (includes concrete pad)	EA	1	\$ 3,500	\$ 3,500
26	Org Waste Station	EA	1	\$ 1,000	\$ 1,000
27	Furnish, place, and fine grade topsoil	SY	2625	\$ 9	\$ 23,625
28	Turf Establishment - Seed	SY	2625	\$ 4	\$ 10,500
29	Shrubs	EA	6	\$ 75	\$ 450
30	Steel Edging	LF	40	\$ 75	\$ 3,000
31	Site Irrigation	SF	5,000	\$ 3	\$ 15,000
32	Tree Fertilization	LS	1	\$ 5,000	\$ 5,000
33	Handrails	LF	30	\$ 175	\$ 5,250
ST	Sub-Total				\$ 607,860
CONT	Contingency on Subtotal at 20%				\$ 122,000
T	Total (to the nearest 1,000)				\$ 730,000

Abbreviations
SY = SQUARE YARD
LF = LINEAR FEET
EA = EACH
LS = LUMP SUM
ALLOW = ALLOWANCE

General Notes:

1. Costs above are based upon conceptual design drawings and should be considered approximate in nature and used for planning purposes only.

#5

PLYMOUTH TRAINING GREEN

65 SANDWICH STREET
PLYMOUTH, MASSACHUSETTS

60% CONSTRUCTION DOCUMENTS
NOT FOR CONSTRUCTION
NOVEMBER 26, 2024
SLR PROJECT # 119SL00126

LOCATION MAP:



GENERAL NOTES

1. ALL WORK SHALL BE IN ACCORDANCE WITH THE LATEST EDITIONS OF THE MASSACHUSETTS DEPARTMENT OF TRANSPORTATION (DOT) SPECIFICATIONS, AND THE LATEST EDITIONS OF THE MASSACHUSETTS DEPARTMENT OF ENVIRONMENTAL AFFAIRS (DEA) REGULATIONS.
2. THE CONTRACTOR SHALL BE RESPONSIBLE FOR OBTAINING ALL NECESSARY PERMITS AND APPROVALS FROM THE APPROPRIATE AGENCIES.
3. THE CONTRACTOR SHALL MAINTAIN ACCESS TO ALL ADJACENT PROPERTIES AND PUBLIC UTILITIES AT ALL TIMES.
4. THE CONTRACTOR SHALL BE RESPONSIBLE FOR PROTECTING ALL EXISTING UTILITIES AND STRUCTURES.
5. THE CONTRACTOR SHALL MAINTAIN ADEQUATE EROSION CONTROL MEASURES THROUGHOUT THE CONSTRUCTION PROCESS.
6. THE CONTRACTOR SHALL BE RESPONSIBLE FOR OBTAINING ALL NECESSARY PERMITS AND APPROVALS FROM THE APPROPRIATE AGENCIES.
7. THE CONTRACTOR SHALL MAINTAIN ACCESS TO ALL ADJACENT PROPERTIES AND PUBLIC UTILITIES AT ALL TIMES.
8. THE CONTRACTOR SHALL BE RESPONSIBLE FOR PROTECTING ALL EXISTING UTILITIES AND STRUCTURES.
9. THE CONTRACTOR SHALL MAINTAIN ADEQUATE EROSION CONTROL MEASURES THROUGHOUT THE CONSTRUCTION PROCESS.
10. THE CONTRACTOR SHALL BE RESPONSIBLE FOR OBTAINING ALL NECESSARY PERMITS AND APPROVALS FROM THE APPROPRIATE AGENCIES.
11. THE CONTRACTOR SHALL MAINTAIN ACCESS TO ALL ADJACENT PROPERTIES AND PUBLIC UTILITIES AT ALL TIMES.
12. THE CONTRACTOR SHALL BE RESPONSIBLE FOR PROTECTING ALL EXISTING UTILITIES AND STRUCTURES.
13. THE CONTRACTOR SHALL MAINTAIN ADEQUATE EROSION CONTROL MEASURES THROUGHOUT THE CONSTRUCTION PROCESS.

PROJECT SITE VICINITY MAP:

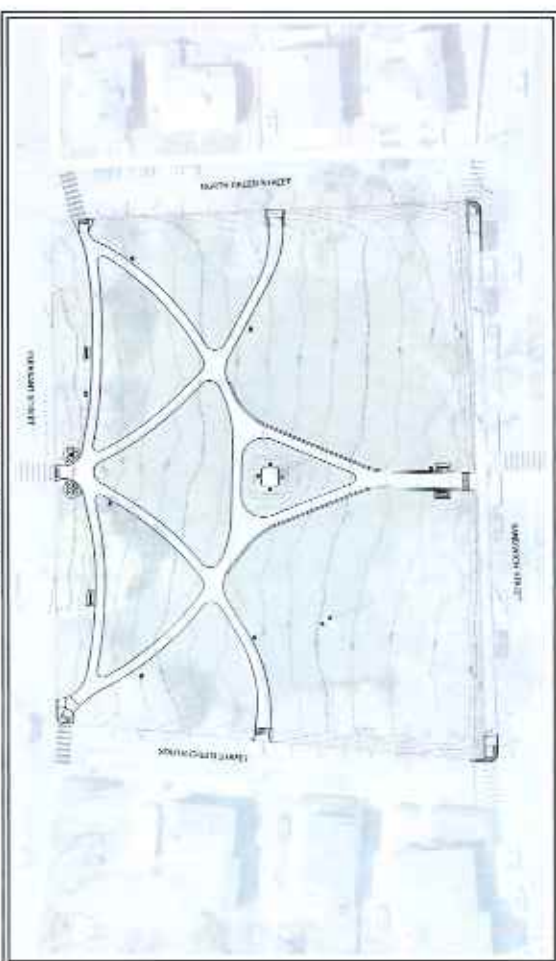

LIST OF DRAWINGS

NO.	DATE	TITLE
01	11/26/24	GENERAL NOTES
02	11/26/24	LOCATION MAP
03	11/26/24	PROJECT SITE VICINITY MAP
04	11/26/24	60% CONSTRUCTION DOCUMENTS
05	11/26/24	NOT FOR CONSTRUCTION
06	11/26/24	NOVEMBER 26, 2024
07	11/26/24	SLR PROJECT # 119SL00126

PREPARED FOR:
PLANNING AND CONSTRUCTION
185 CANTRELL DRIVE
PLYMOUTH, MA 01960

PREPARED BY:
SLR



Find us at below,
Call before you dig,
www.slr.com

[illegible]

1. ERTY "O" GRADED TONN OF WYOMING ASTER AND AVERAGE PLANTING
2. GOOD PLANT 5-AT TONNED AND THE IS WITH WYOMING ASTER 20 WYOMING

[illegible]

NOT FOR CONSTRUCTION

[illegible]

SOIL EROSION AND SEDIMENT CONTROL

NARRATIVE

THESE EROSION AND SEDIMENT CONTROL MEASURES ARE BASED ON THE ASSUMPTION THAT THE CONSTRUCTION OF THIS PROJECT WILL BE COMPLETED WITHIN THE SPECIFIED TIME FRAME. IF THE PROJECT IS COMPLETED LATER THAN THE SPECIFIED TIME FRAME, THE EROSION AND SEDIMENT CONTROL MEASURES WILL BE REVIEWED AND MODIFIED AS APPROPRIATE. THE EROSION AND SEDIMENT CONTROL MEASURES ARE BASED ON THE ASSUMPTION THAT THE CONSTRUCTION OF THIS PROJECT WILL BE COMPLETED WITHIN THE SPECIFIED TIME FRAME. IF THE PROJECT IS COMPLETED LATER THAN THE SPECIFIED TIME FRAME, THE EROSION AND SEDIMENT CONTROL MEASURES WILL BE REVIEWED AND MODIFIED AS APPROPRIATE.

EROSION AND SEDIMENT CONTROL CONSTRUCTION SEQUENCE

1. EROSION AND SEDIMENT CONTROL MEASURES SHALL BE INSTALLED PRIOR TO THE START OF CONSTRUCTION.
2. EROSION AND SEDIMENT CONTROL MEASURES SHALL BE MAINTAINED THROUGHOUT THE CONSTRUCTION PROCESS.
3. EROSION AND SEDIMENT CONTROL MEASURES SHALL BE REMOVED UPON COMPLETION OF THE PROJECT.
4. EROSION AND SEDIMENT CONTROL MEASURES SHALL BE REINSTALLED IF NECESSARY.

EROSION CONTROL LEGEND

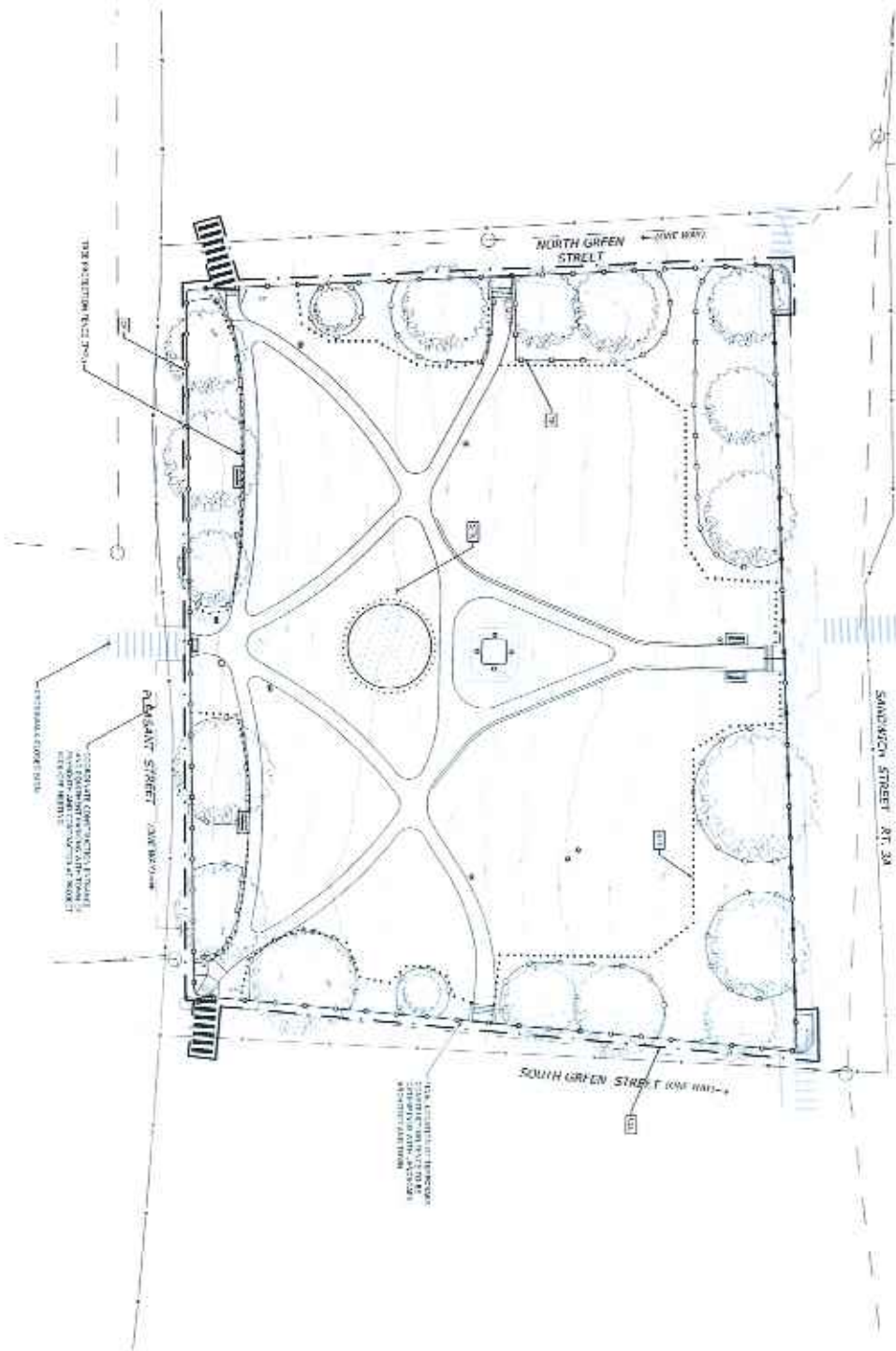
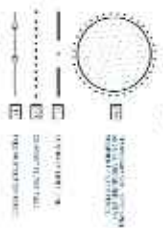

DESCRIPTION	DATE	BY



SEDIMENT AND EROSION CONTROL PLAN
PLYMOUTH TRAINING GREEN
88 RAINBOW STREET
PLYMOUTH, MASSACHUSETTS

NOT FOR CONSTRUCTION

DATE	11/11/2023
BY	SLR
REVISION	1
DESCRIPTION	NOVEMBER 11, 2023
THICKNESS	11/11/2023
SCALE	11/11/2023
SE	

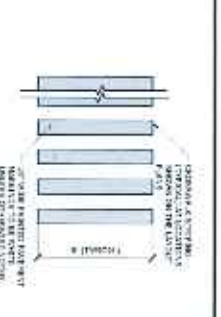
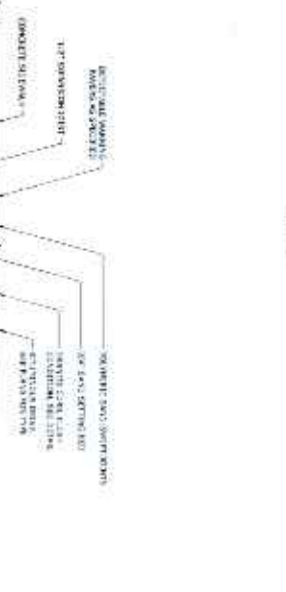
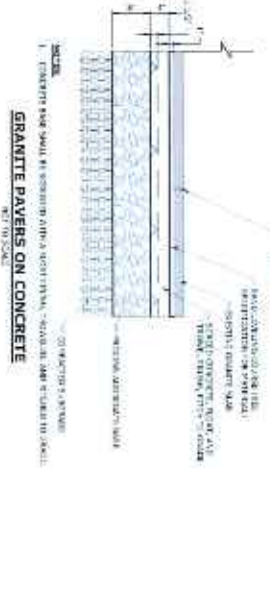
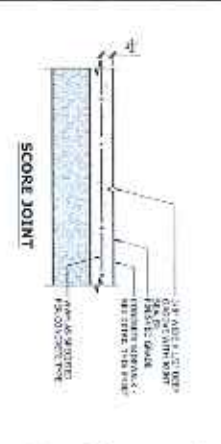
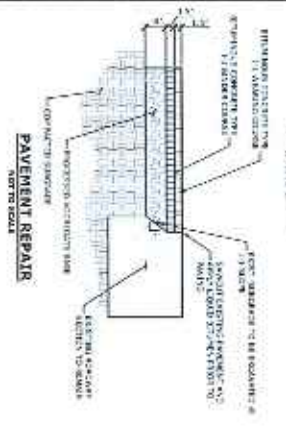
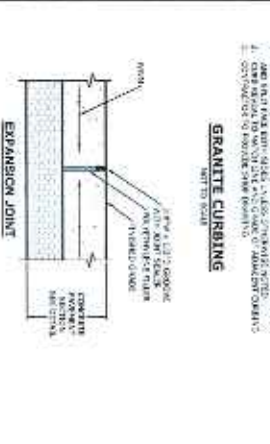
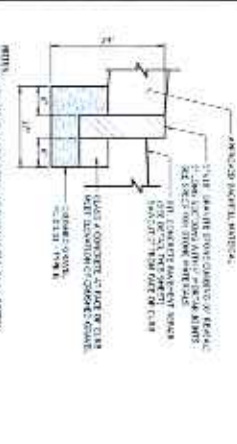

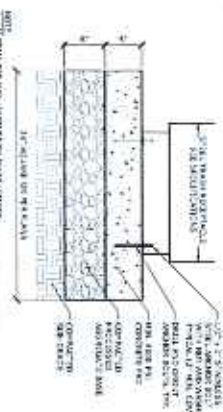

SURFACE MOUNTED TRASH AND RECYCLING RECEPTACLE
N7 TO SCALE

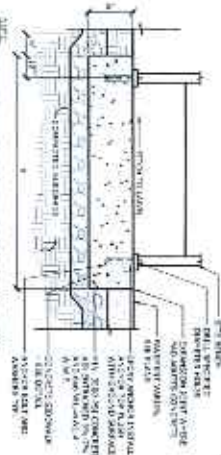

SURFACE MOUNTED BENCH
N7 TO SCALE

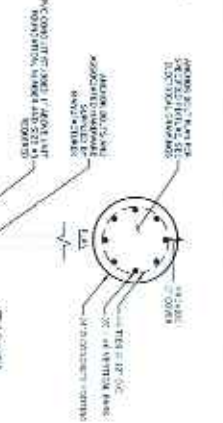

LIGHT POLE FOUNDATION DETAIL
N7 TO SCALE

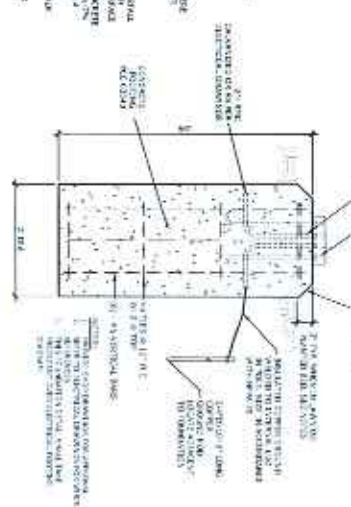

LANDSCAPE BEDS
N7 TO SCALE

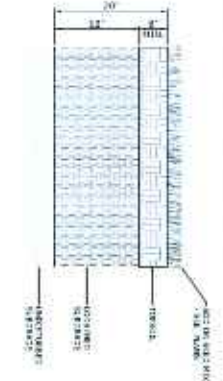

LAWN DETAIL
N7 TO SCALE

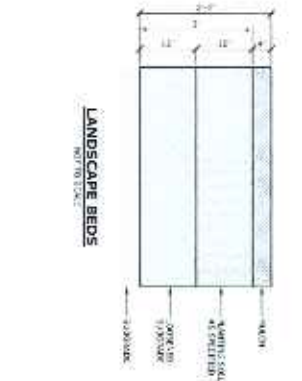

STEEL LANDSCAPE EDGING
N7 TO SCALE

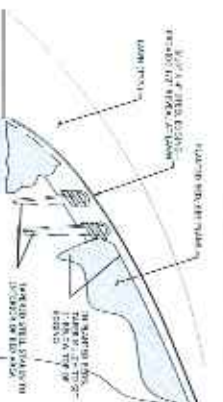

SHRUB PLANTING
N7 TO SCALE

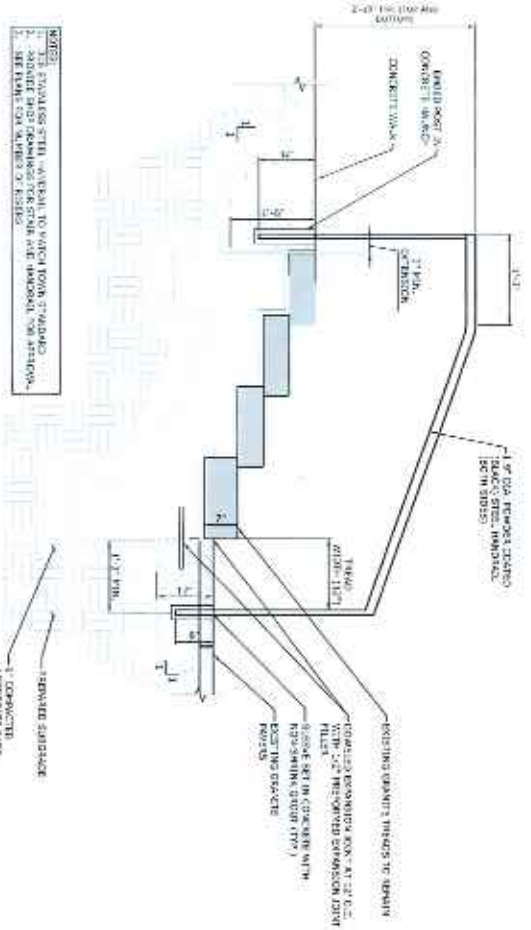

POWDER COATED STEEL HANDRAIL
SCALE: 1/8\"/>

NOTES:
1. ALL MATERIALS SHALL BE IN ACCORDANCE WITH THE LATEST EDITIONS OF THE FOLLOWING:
A. AIAA 1000-2015
B. AIAA 1000-2015
C. AIAA 1000-2015
D. AIAA 1000-2015
E. AIAA 1000-2015
F. AIAA 1000-2015
G. AIAA 1000-2015
H. AIAA 1000-2015
I. AIAA 1000-2015
J. AIAA 1000-2015
K. AIAA 1000-2015
L. AIAA 1000-2015
M. AIAA 1000-2015
N. AIAA 1000-2015
O. AIAA 1000-2015
P. AIAA 1000-2015
Q. AIAA 1000-2015
R. AIAA 1000-2015
S. AIAA 1000-2015
T. AIAA 1000-2015
U. AIAA 1000-2015
V. AIAA 1000-2015
W. AIAA 1000-2015
X. AIAA 1000-2015
Y. AIAA 1000-2015
Z. AIAA 1000-2015

